

Pond Checklist

Tax Parcel# _____ Submitted by: _____

Pond Standards

- A. Any pond 200 square feet or greater shall be considered a structure, shall comply with setbacks for structures pursuant to Chapter 7, Sauk County Zoning Ordinance, and shall require a land use permit.
- B. Any pond, which through the process of digging, excavating or scraping, creates spoils which are stockpiled onsite or removed from the property, shall be considered a mining operation and must comply with all mining regulations and obtain appropriate permits pursuant to Chapter 7, Chapter 24 and NR 135 where applicable.
- C. Any pond 200 sq ft or greater and within 75 feet of a property line or road right of way shall require the approval of a special exception permit.

Calculation of the area that will be affected by this project. Include all cut, fill, leveling, or stockpile areas or any other areas such as haul roads where bare soils will be exposed. _____ sq. ft.

The site is / is not within 300 feet of a navigable waterway. (Circle one)

The site is / is not in a mapped floodplain. (Circle one) If it is, floodplain panel number: _____

The site is / is not in a protected wetland. (Circle one) If yes, see Standard below for Shoreland/Wetland District.

Spoil will / will not be removed from the parcel. (Circle one)

Spoil from any excavation is to be disposed of at: (provided legal description and be as specific as possible) _____

The pond is / is not an enlargement of a stream or any other waterway. (Circle one)

If not, how far will the pond be from the nearest creek, river or other waterway? _____ ft Which is _____
name

Anticipated depth of excavation _____ Anticipated water depth _____

Time table for the commencement and restoration of the site _____

The pond will / will not have an outlet (Circle one)

The pond will / will not have a berm. If so, is the berm described on the plot plan. Yes/No (If no, plot plan needs to be revised.)

If pond is located in a Shoreland/Wetland District the Permit meets all these criteria per s.8.006(4)(c)

- The excavated pond may not exceed a depth of 4 feet.
- Pond banks shall be sloped to 3:1 or flatter.
- All disturbed areas associated with the pond construction must be stabilized.
- All debris piles, brush piles, tree stumps, and other material associated with pond construction may not be placed or located within the shoreland-wetland district (this is shown on the plot plan).

* If deemed necessary, the Department shall require safety measures to protect the public from the excavated pond including fencing and gates.

Engineering Required (check if any apply)

Engineered Filling or Grading Criteria s. 8.013(4):

(a) For filling or grading of any area which is within 300 feet landward of the ordinary high water mark of navigable water, has surface drainage toward the water, and on which there are any of the topographic conditions listed below:

- 1. Any filling or grading on slopes of more than 20%.
- 2. Filling or grading of more than 1,000 square feet on slopes of 12% to 20%.
- 3. Filling or grading of more than 2,000 square feet on slopes less than 12%.

(b) For constructing, dredging, or enlarging of any artificial water body that connects with a navigable waterway.

(c) For the construction or enlargement of an artificial body of water that is or will be located within 300 feet landward of the ordinary high water mark of, but that does not connect with, an existing navigable waterway.

Setback Survey Required *A survey is required when any part of the structure is located within 10 feet of any setback. The survey is due at the time the foundation for the structure is finished. Failure to follow this condition shall result in a stop work order and possible enforcement action. Refer to Sec. 7.153(7)

Pond Checklist

Plans attached shall include a plot plan and cross section plan which include the following:

- | | | | |
|--|--|---|---|
| <input type="checkbox"/> North arrow | <input type="checkbox"/> Setbacks to property lines | <input type="checkbox"/> Contours | <input type="checkbox"/> Wetland Boundaries |
| <input type="checkbox"/> Property lines | <input type="checkbox"/> Location of pond/excavation | <input type="checkbox"/> POWTS | <input type="checkbox"/> Overflows/spillways |
| <input type="checkbox"/> Erosion control plans | <input type="checkbox"/> Floodplain boundaries | <input type="checkbox"/> All structures | <input type="checkbox"/> Areas of disturbed soils |
| <input type="checkbox"/> Stockpiles | | | |

SAMPLE POND PLAN

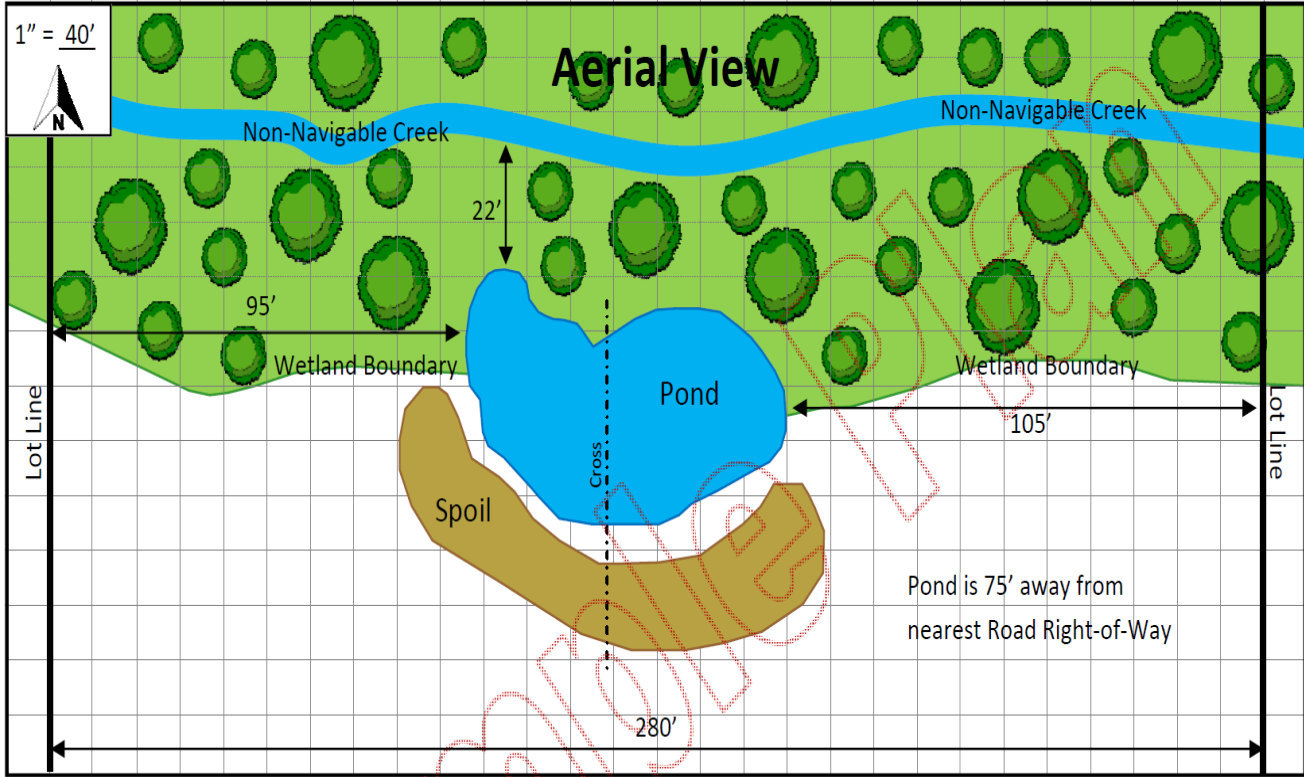

Cross Section Plans shall have the following:

- | | | | |
|---|---|--------------------------------|--|
| <input type="checkbox"/> Existing grade | <input type="checkbox"/> Dimensions/height of any berms/dikes | <input type="checkbox"/> Slope | <input type="checkbox"/> Proposed finished grade |
| <input type="checkbox"/> Proposed water elevation | | | |

